



# BIMETAL THERMOMETERS ADJUSTABLE ANGLE TYPE

Every angle adjustable type thermometer

Features anti-vibration design, anti-parallax dial and hermetically sealed

## SPECIFICATIONS

Dial	3" (76 mm), 5" (130 mm) Anti-parallax dial design
Case	Stainless steel, hermetically sealed
Stem	316 stainless steel welded to connection
Lens	Glass
Pointer	Black aluminum
Connection	Adjustable angle 1/2" NPT on 3" & 5"
Scale	Standard: dual scale F & C
Accuracy	1% full scale per Grade A, ASME B40.3
Ambient Temp*	-30° F to 180° F
External Adjustment	Zero reset screw on 3" & 5" dial

*Design meets or exceeds ASME B40.3 thermometer standard.*



## AVAILABLE OPTIONS\*

- Certificate of Accuracy, NIST traceable
- Custom Dial
- Special Connection Size
- Single Scale
- Special Ranges
- Custom Lens Material

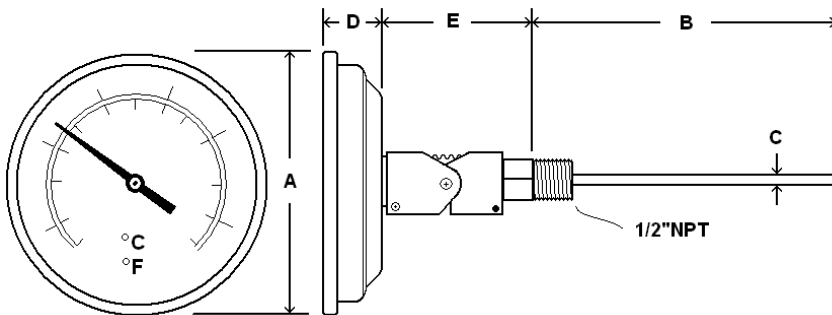

Dial	Unit	A	B	C	D	E	F
3"	In.	3.27"	Stem Length	0.25"	0.82"	2.45"	1/2" NPT
	mm	83	Stem Length	6.45	21	62	
5"	In.	5.28"	Stem Length	0.25"	0.82"	2.45"	1/2" NPT
	mm	134	Stem Length	6.45	21	62	

\*Lead times/minimums may apply

## APPROXIMATE SHIPPING WEIGHTS/ BOX QUANTITIES

Dial Size	Est. Unit Weight	Box Qty
3"	1.00 lbs (0.40 kg)	upon request
5"	1.40 lbs (0.60 kg)	upon request

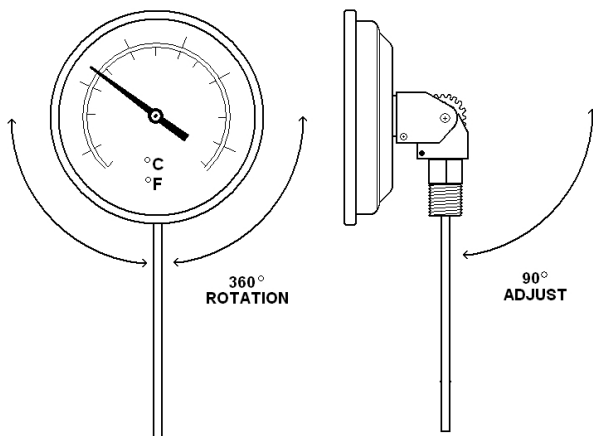

\*NOTE: High or low ambient temperatures may have adverse effect on accuracy.  
Consult PIC Gauges for instrument selection.