

# 6001 6" ALL STAINLESS LOWER MOUNT



Heavy duty, all stainless steel gauge with removable bezel, adjustable pointer  
1% accuracy, welded case-to-stem connection, dry yet fillable

## SPECIFICATIONS

|              |   |
|--------------|---|
| Dial         | 6" (150 mm)   |
| Case         | Stainless steel, dry yet fillable<br>Welded case-to-stem connection |
| Wetted Parts | 316 stainless steel   |
| Movement     | With overload/underload stops                                       |
| Bezel        | Removable, stainless steel  |
| Lens         | Laminated safety glass  |
| Pointer      | Micro adjustable, black aluminum                                    |
| Connection   | Lower mount<br>1/4" or 1/2" NPT                                     |
| Scale        | Standard: single scale psi  |
| Accuracy     | 1% of span ASME B40.1 Grade 1A                                      |
| Ambient Temp | Dry = -30° F to 180° F<br>Glycerine Filled = 30° F to 160° F        |

*Design meets or exceeds ASME B40.100 pressure gauge standard.*



4

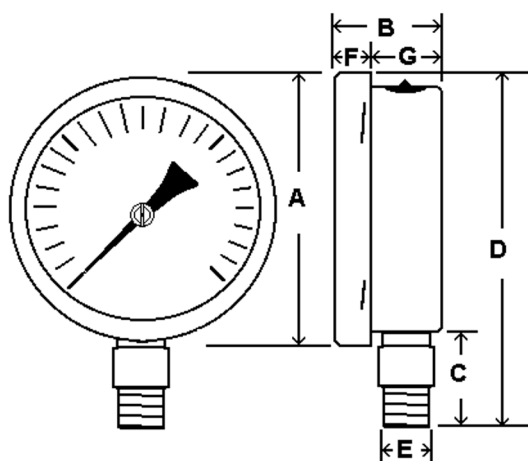

## AVAILABLE OPTIONS\*

- Certificate of Accuracy, NIST traceable
- Custom Dial
- Liquid Fill Options, see page 176
- Special Connection Size
- Cleaned for Oxygen Service (dry only)
- Polycarbonate Lens

\*Lead times/minimums may apply

## APPROXIMATE SHIPPING WEIGHTS/ BOX QUANTITIES

| Dial | Unit | A     | B     | C     | D     | E        | F     | G     |
|------|------|-------|-------|-------|-------|----------|-------|-------|
| 6"   | In.  | 6.75" | 2.05" | 1.50" | 8.41" | 1/4" or  | 0.73" | 1.27" |
|      | mm   | 172   | 52    | 38    | 214   | 1/2" NPT | 18    | 32    |

| Dial Size | Est. Unit Wt.         | Box Qty |
|-----------|-----------------------|---------|
| 6"        | 2.15 lbs<br>(0.98 kg) | 10      |