

# LP1-PS LOW PRESSURE PHENOLIC CASE



**Capsule type pressure gauge for accurate measurement of low pressures**  
**Suitable for air, water, oil, gas or any other media not corrosive to stainless steel**

## SPECIFICATIONS

<b>Dial</b>	4 1/2" (115 mm)
<b>Case</b>	Phenolic, dry non-fillable
<b>Wetted Parts</b>	316 stainless steel
<b>Bezel</b>	Phenolic
<b>Lens</b>	Tempered glass
<b>Pointer</b>	Adjustable, black aluminum Adjustment screw on dial face
<b>Connection</b>	Lower mount 1/2" or 1/4" NPT
<b>Scale</b>	Standard: single scale inches of water column or psi
<b>Accuracy</b>	2-1-2% of span ASME B40.1 Grade A
<b>Ambient Temp</b>	-30° F to 180° F

*Design meets or exceeds ASME B40.100 pressure gauge standard.*

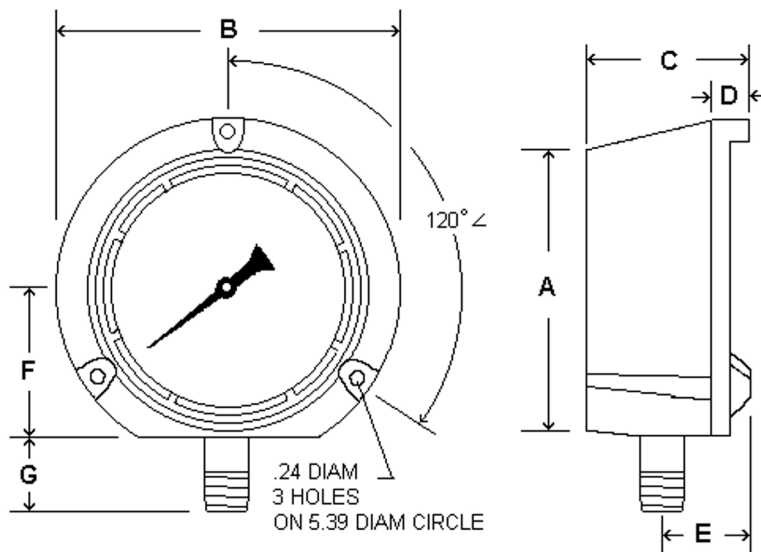

Dial	Unit	A	B	C	D	E	F	G	NPT
4 1/2"	In.	5.10"	5.83"	3.23"	1.07"	1.65"	2.60"	1.41"	1/4" or 1/2"
	mm	130	148	82	27	42	66	36	

## AVAILABLE OPTIONS\*

- Certificate of Accuracy, NIST Traceable
- Custom Dial
- Special Connection Size
- Other Lens Material
- Cleaned for Oxygen Service
- Dual Scale

\*Lead times/minimums may apply

## APPROXIMATE SHIPPING WEIGHTS/ BOX QUANTITIES

Dial Size	Est. Unit Wt.	Box Qty
4 1/2"	2.10 lbs (0.96 kg)	upon request

## STANDARD DIAL CONFIGURATIONS FOR LP1-PS SERIES

Dial Range	Figure Intervals	Graduation Intervals	Dial Range	Figure Intervals	Graduation Intervals	Dial Range	Figure Intervals	Graduation Intervals
200/0"wc Vac	20" wc	2" wc	0/15" wc	3" wc	0.2" wc	0/100" wc	20" wc	2" wc
100/0"wc Vac	10" wc	1" wc	0/30" wc	5" wc	0.5" wc	0/200" wc	20" wc	2" wc
30/0"wc Vac	5" wc	0.5" wc	0/60" wc	10" wc	0.5" wc			

Because of continuing improvements, increments and specifications are subject to change without notice. Consult PIC Gauges for availability.